

Vacuum Cup Suspension Assemblies

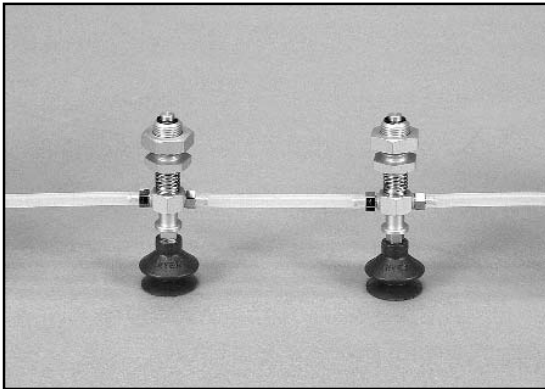

Side Ported Spring Suspensions



ANVER Level Compensators are used to compensate differences in cup height, particularly on lifting devices with several suction cups on one frame. When a vacuum cup is used in handling robots or similar devices, a level compensator is often advantageous because it places fewer demands on exact vertical positioning. These level compensators also provide a certain amount of shock absorption.

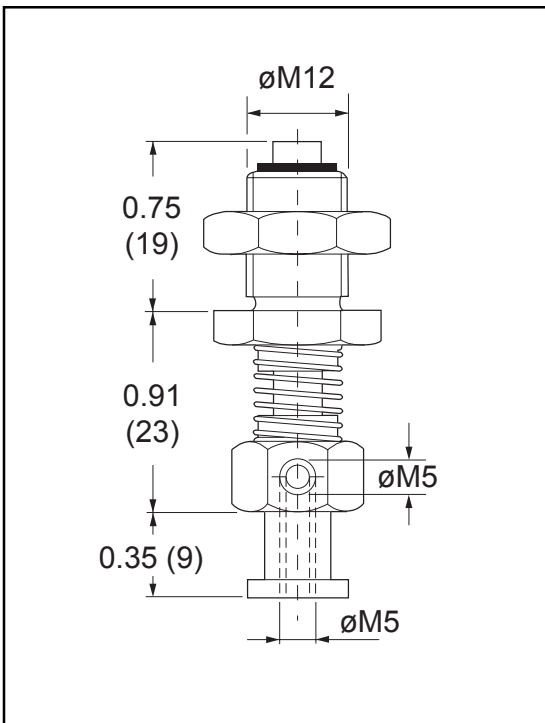

► This spec sheet was adapted for print from our website. Additional information and photos are available at www.anver.com. 2031301